



P VERSA
PREMIER

CUDR1-24VCP-R

COOLER FB 1DR UNDERCOUNTER S/S RH 24in

WARRANTY:
TWO YEAR PARTS AND
LABOUR; FIVE YEARS ON
COMPRESSOR

SPECIFICATIONS SUBJECT TO
CHANGE WITHOUT NOTICE.

FIND
ADDITIONAL
BENEFITS
HERE



CUDR1-24VCP-R
24 INCH 1 DOOR FRONT BREATHING
UNDERCOUNTER COOLER RIGHT HINGE

- Premium quality materials and craftsmanship
- Front air flow directed ventilation system
- Finger-print resistant heavy-gauge Stainless Steel exterior finish
- Clear coated Aluminum Liner
- Adjustable Heavy-Duty Epoxy coated shelves
- Casters for easy movement
- Locking Doors magnetic door gaskets
- 2" inserted caster for low unit height
- Sophisticated Digital Controller to ensure steady temp range from 33 to 40°F (0 to 4°C)
- Positive Seal self-closing doors w/stay open feature
- Automatic defrost system
- Environmentally friendly R290 hydro carbon refrigerant
- Bluetooth and Wi-Fi connectivity ready
- Available EFI Cold Connect™ Monitoring Service (extra charge applies)
- Extended 5-year warranty included with EFI Cold Connect™ subscription

ADDITIONAL IMAGES



**DIGITAL
CONTROLLER**



**WIFI COLD
CONNECT™**



**FRONT
BREATHING**



**2" INSERTED
CASTERS**



DOOR LOCK

MODEL DESIGNATIONS



ADDITIONAL RESOURCES

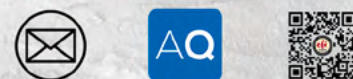

CUDR1-24VCP-R

COOLER FB 1DR UNDERCOUNTER S/S RH 24in

DIMENSIONS

Dimensions	Width		Depth		Height		Weight	
	Inches	mm	Inches	mm	Inches	mm	Lbs	KG
Exterior	24.0	610.0	25.8	655.0	31.6	802.0	119.0	54.0
Shipping	26.0	660.0	28.3	720.0	37.4	950.0	144.4	65.5
Interior	20.1	510.0	20.6	522.0	24.4	620.0		

TECHNICAL

Capacity	Doors	Shelves	Casters	HP	Amps	Voltage	Refrig	Plug	Cord len
120/4.2	1	2	2"	1/6	1.8	115/60	R290	5-15P	≥1.8m

LINE DRAWINGS

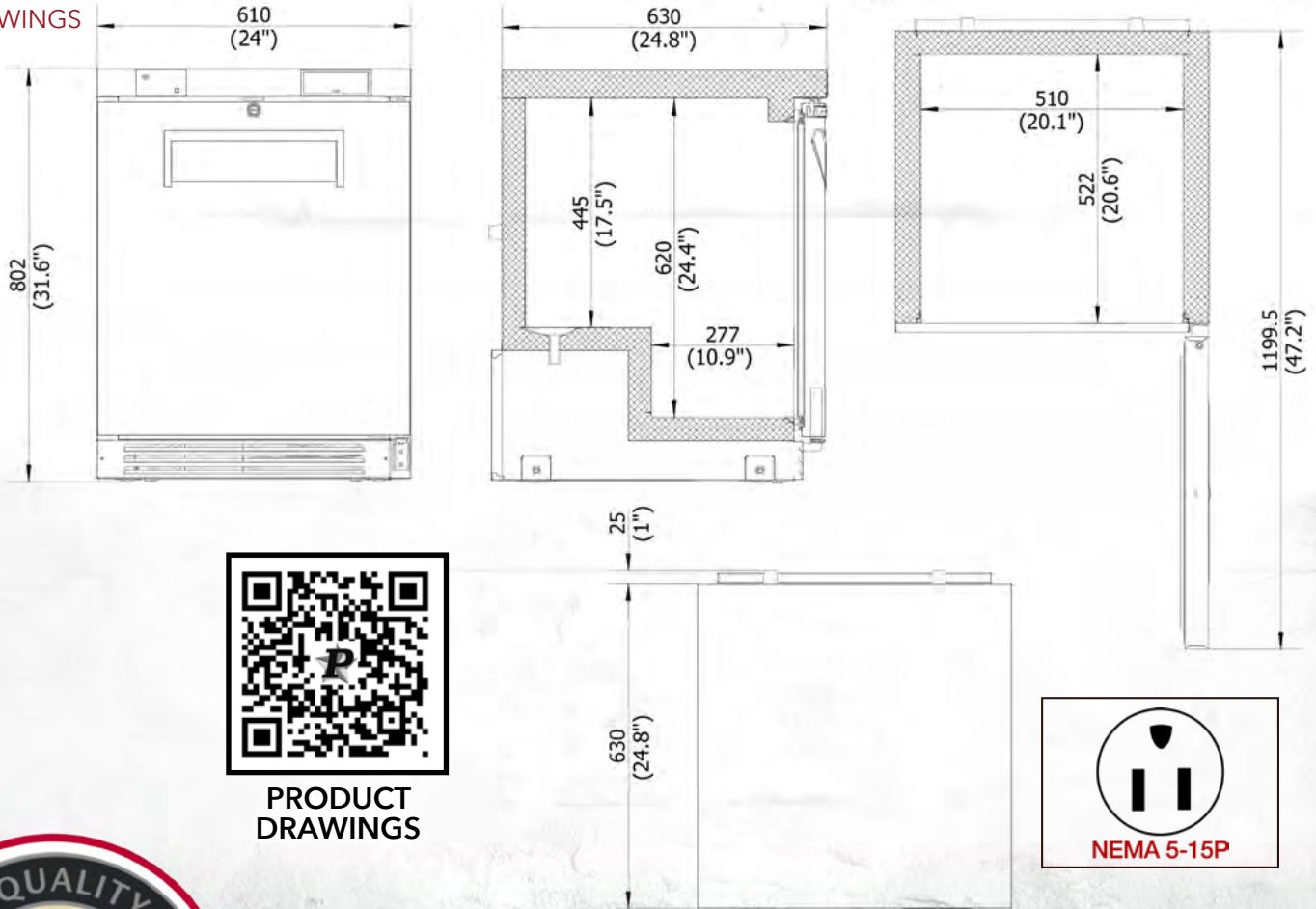

EFI Sales Ltd.
 Toronto Office & DC
 515 Hanlon Creek Blvd.
 Guelph, ON, N1C 0A1

EFI Sales Ltd.
 Vancouver Office & DC
 26895 Gloucester Way
 Langley, BC, V4W 3Y3

(888) 565-9920 Toll Free
 (519) 822-1895 Toronto
 (604) 607-8850 Vancouver